

Infant Interface Set-up Guide

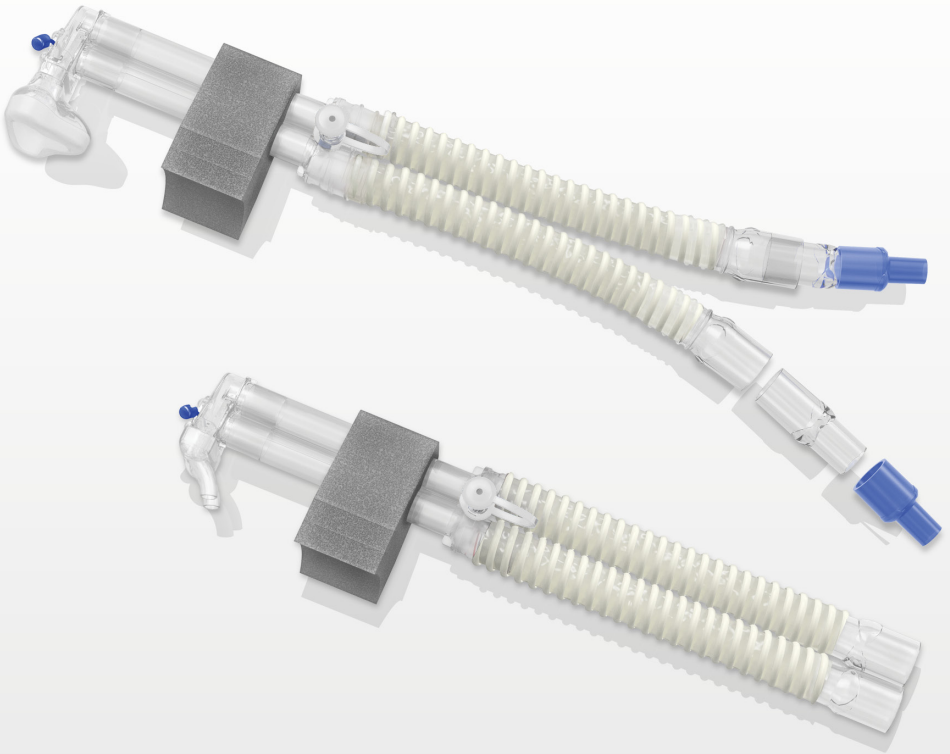





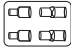

For full User Instructions, please refer to FlexiTrunk™ Infant Interface User Instructions (PN 185042952).

FlexiTrunk™ SIZING GUIDE

The following guide illustrates the possible product size range that can be used on infants grouped according to weight. Individual infants may vary. Actual measurements using the sizing guide should be carried out for ideal fit and optimum therapy delivery.

GUIDE FOR PRODUCT SIZE RANGE FOR INFANTS ACCORDING TO WEIGHT

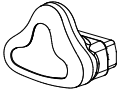
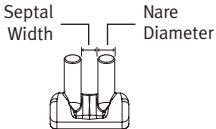
	PRODUCT CODE	PRODUCT SIZE	INFANT WEIGHT (APPROX)		
			≤ 1500 g	≤ 2500 g	> 2500 g
  Standard (BC18x Series)	BC180-05	50 mm	•		
	BC190-05				
Universal (BC19x Series) with connectors	BC181-05	70 mm	•	•	
	BC191-05				
	BC182-05	100 mm		•	•
	BC192-05				
	BC300-05	17-22 cm	•		
	BC303-05	22-25 cm	•	•	
	BC306-05	25-29 cm		•	
	BC309-05	29-36 cm		•	•
	BC325-05	29-36 cm			•
	BC328-05	35-40 cm			•
	BC331-05	40-45 cm			•
	BC351-10	20-26 cm	•		
	BC353-10	26-32 cm	•	•	
	BC355-10	32-38 cm		•	
	BC357-10	38-44 cm		•	•
	BC800-10	Small	•		
	BC801-10	Medium	•	•	
	BC802-10	Large		•	•
	BC803-10	Extra Large			•
	BC3020-10	3.0 mm/2.0 mm*	•		
 Septal Width Nare Diameter *3.0 mm/2.0 mm Nare Diameter/Septal Width	BC3520-10	3.5 mm/2.0 mm	•		
	BC4030-10	4.0 mm/3.0 mm	•	•	
	BC4540-10	4.5 mm/4.0 mm		•	
	BC5040-10	5.0 mm/4.0 mm		•	
	BC5050-10	5.0 mm/5.0 mm		•	•
	BC5550-10	5.5 mm/5.0 mm		•	•
	BC5560-10	5.5 mm/6.0 mm			•
	BC6060-10	6.0 mm/6.0 mm			•
	BC6070-10	6.0 mm/7.0 mm			•
	BC6570-10	6.5 mm/7.0 mm			•

FlexiTrunk™ INTERFACE SET-UP



- Measure the infant's head circumference in centimeters.

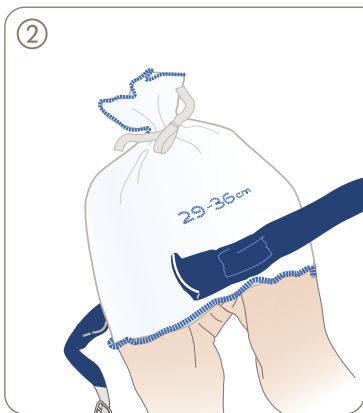

- Choose the correct-sized Bonnet. The Bonnet should be snug fitting.
- Stretch the Bonnet with your hands initially for ease of placement.

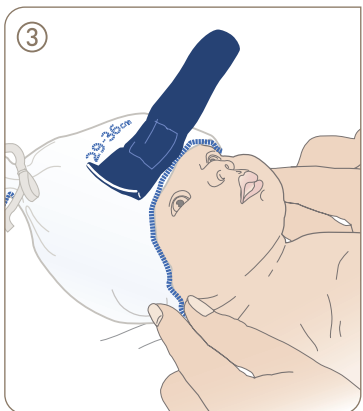

- Slip the Bonnet onto the infant's head, completely covering the ears and with the back edge of the Bonnet at the base of the neck. The front edge of the Bonnet should be just above or on the eyebrows.  DO NOT cover the infant's face with the Infant Bonnet as suffocation may occur.

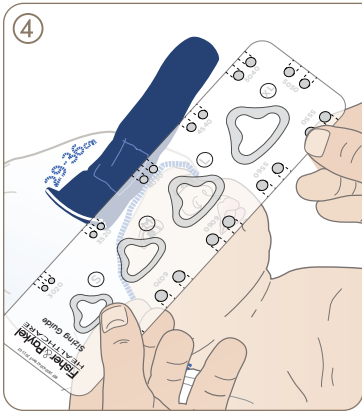

- Use the sizing guide to choose suitable prongs or mask.
- Prongs should fill the nares completely without stretching the skin. Use the biggest size possible.
- The mask should not touch the edge of the nose, septum or the eyes.

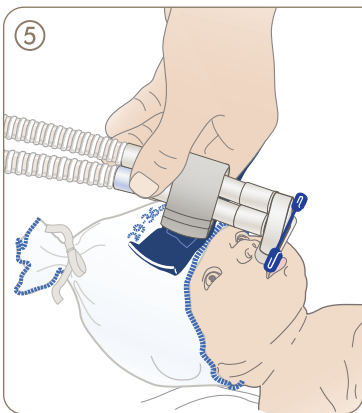

- Choose the correct length of the nasal tubing. Use the shortest length possible.
- The clear tubing should not extend over the infant's forehead.
- The following may be used as a guide:
 - 50 mm ≤ 1.5 kg
 - 70 mm ≤ 2.5 kg
 - 100 mm > 2.5 kg

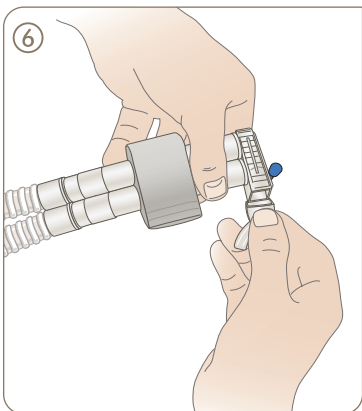

- Connect the prongs or mask to the nasal tubing ensuring that it is fully inserted.
- If using prongs: squeeze sides of prongs firmly to expose grooves. Start from one end and insert the prong grooves into the nasal tubing. Push the end in firmly.

FlexiTrunk™ INTERFACE SET-UP

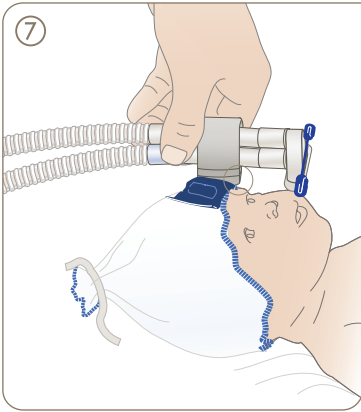

- Remove the tear-off foam strips as required to adjust the nasal tubing angle to optimize the seal.
- DO NOT discard the tear-off strips as they may be needed when alternating between nasal prongs and masks.
- The tubing should be parallel to the infant's face (not slanted upwards or downwards).

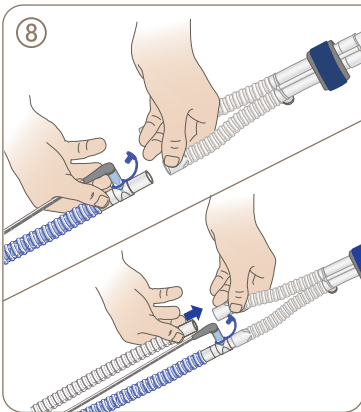

- Attach the circuit to the nasal tubing in either orientation. Refer to instructions provided by circuit manufacturer for more detailed information.
- Note: Disconnect FlexiTrunk gently by twisting the connectors. DO NOT pull forcefully, as this may damage the tubing.



Handle with care.

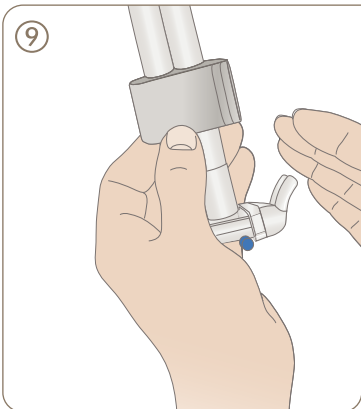

- Set gas flow to prescribed level.
- Turn the humidifier on. Refer to manufacturer's instructions.
- ⚠ Place hand close to nasal prongs or mask to ensure there is gas flow present.

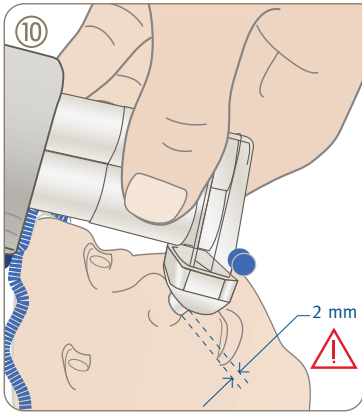

- **If using prongs:** Clear nasal secretions before inserting the nasal prongs.
- ⚠️ Ensure the nasal prongs are positioned at least 2 mm (0.08 inches) from the septum to avoid pressure necrosis. Adjust as necessary.
- Hourly checks of the septum integrity are recommended.

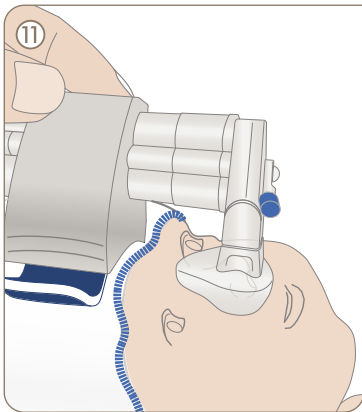

- **If using mask:** Connect to patient by placing mask around nose. The mask should sit comfortably around the patient's nose. It must not occlude the nostrils or touch the septum and should not be over the lip or over the eyes.

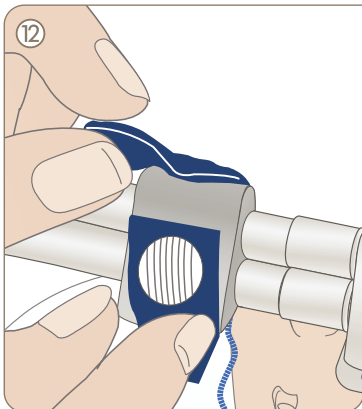

- **Changing from prongs to mask:** Add foam block strips as required for proper positioning of the mask.
- Place the strap over the foam block and tighten to hold the tubing firmly in place.
- The tubing should be parallel to patients face (not slanted upwards or downwards).

FlexiTrunk™ INTERFACE SET-UP

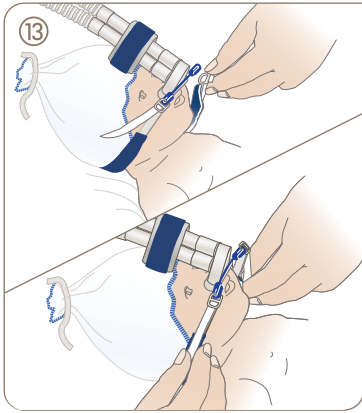

- Hook the clips from the side straps of the bonnet to the glider.
- Pull both straps at the same time for central positioning.
- Affix the round Velcro tabs to the blue strap of the bonnet.
- Use the least tension possible to maintain the prescribed CPAP level and stability of the Infant Interface.

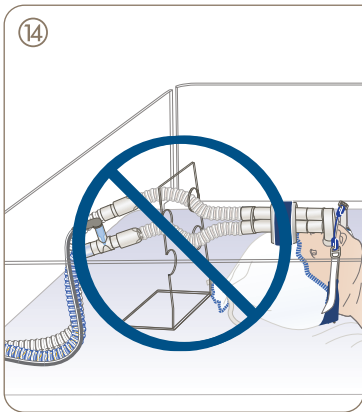

- DO NOT use circuit holders or similar devices as they can puncture the FlexiTrunk tubing and cause loss of pressure.

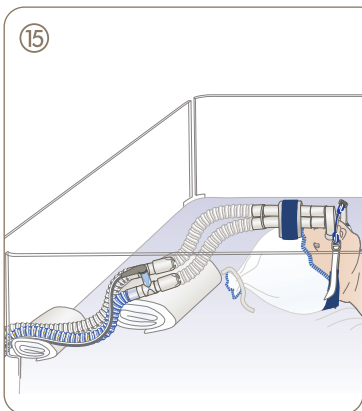

- Ensure the weight of the circuit is gently supported to reduce tension on the nasal tubing. A pillow or folded towel is recommended. The FlexiTrunk tubing must have free movement to allow the infant's head to move without restriction.
- The circuit should be kept below the level of the nasal tubing to minimize condensate at the infant.



For more information please contact
your local Fisher & Paykel Healthcare representative

Manufacturer 

Fisher & Paykel Healthcare Ltd
15 Maurice Paykel Place
East Tamaki, Auckland 2013

PO Box 14 348, Panmure
Auckland 1741
New Zealand

Tel: +64 9 574 0100
Fax: +64 9 574 0158
Email: info@fphcare.com
Web: www.fphcare.com

Australia

Fisher & Paykel Healthcare Pty Limited
36-40 New Street, PO Box 167
Ringwood, Melbourne
Victoria 3134, Australia

Tel: +61 3 9879 5022
Fax: +61 3 9879 5232

Austria

Tel: 0800 29 31 23
Fax: 0800 29 31 22

Benelux

Tel: +31 40 216 3555
Fax: +31 40 216 3554

China

Tel: +86 20 3205 3486
Fax: +86 20 3205 2132

France

Tel: +33 1 6446 5201
Fax: +33 1 6446 5221

Germany

Tel: +49 7181 98599 0
Fax: +49 7181 98599 66

India

Tel: +91 80 4284 4000
Fax: +91 80 4123 6044

Irish Republic

Tel: 1800 409 011

Italy

Tel: +39 06 7839 2939
Fax: +39 06 7814 7709

Spain

Tel: +34 902 013 346
Fax: +34 902 013 379

Sweden

Tel: +46 8 564 76 680
Fax: +46 8 36 63 10

Switzerland

Tel: 0800 83 47 63
Fax: 0800 83 47 54

Taiwan

Tel: +886 2 8751 1739
Fax: +886 2 8751 5625

Turkey

Tel: +90 312 354 34 12
Fax: +90 312 354 31 01

UK 

Fisher & Paykel Healthcare Ltd
Unit 16, Cordwallis Park
Clivemont Road, Maidenhead
Berkshire SL6 7BU, UK

Tel: +44 1628 626 136
Fax: +44 1628 626 146

USA/Canada

Tel: +1 800 446 3908
or +1 949 453 4000
Fax: +1 949 453 4001