

### Warnings:

- Please read and understand the instructions fully before using the Neopuff™ Infant Resuscitator and related accessories. The Neopuff Infant Resuscitator is to be used only by persons trained in infant resuscitation.
- It is the responsibility of the purchaser to ensure that all users of this device have been adequately trained in resuscitation techniques.



*This swingtag is only to be used as a guide to set-up. Always read and understand all user instructions for each component before use.*

### Set-Up

- ⚠** Consult the user instructions for the Neopuff™ Infant T-Piece Resuscitation Device, MR850/MR810 Humidifier and MR225/MR290 Chambers for additional user information and warnings.

#### 1 Insert Humidification Chamber

- ⚠** Discard the chamber if the seals are not intact when received.
- Slide a MR225 or MR290 chamber onto the humidifier base.
  - Remove the blue caps.
  - If using a manual-fill chamber (MR225), fill with 30 mL of sterile water or equivalent. This will allow for 60 minutes of running time (@8 L/min flowrate) and then refill as necessary during resuscitation.

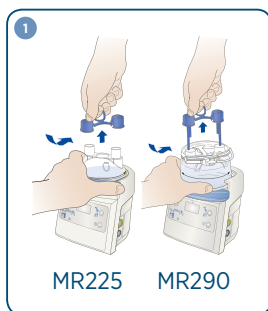

#### 2 MR290 - Connect Water Bag

- Hang the water bag, unwind the waterfeed set and spike water bag.
- Open the vent on the vented spike.
- Check the humidification chamber for water flow from the bag.
- If no water is visible in the chamber or water consumption is low, check that the bag is spiked properly and that the feed tube is not kinked or blocked. Try gently squeezing the bag to promote water flow. Ensure that the height of the water bag is at least 50 cm higher than the humidification chamber.
- Discard the chamber if the water level exceeds the maximum water level line.

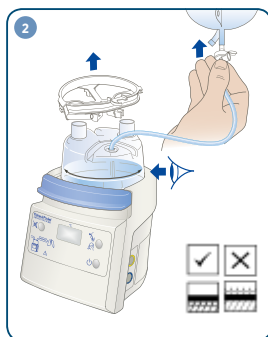

#### 3 Connect Circuit between the Neopuff and Chamber

- Connect the blue dry-line circuit (without heater wire) between the Neopuff gas outlet port and one of the chamber inlet ports.

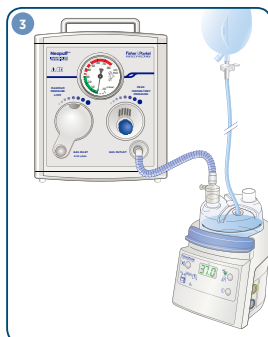

*This swingtag is only to be used as a guide to set-up. Always read and understand all user instructions for each component before use.*

### 4 Connect T-Piece Circuit

- Connect the blue inspiratory tube (with T-Piece) to the remaining chamber port.
- Open the two blue caps on the inspiratory tube and insert the temperature probes.
- Plug the temperature probe into the humidifier (blue plug).
- Insert the heater wire adaptor into the humidifier (yellow plug) and then insert the probe into the end of the blue inspiratory tube (close to chamber).
- Ensure that the temperature probes and the heater wire adaptor are fully inserted. If temperature probes are not used (i.e. using MR810), ensure the two blue caps are placed over the ports.

⚠ Discard blue inspiratory tube if the heater-wire (within tube) is not evenly distributed along the circuit length and is bunched or kinked.

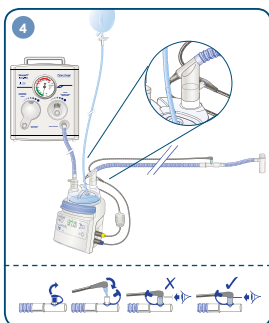

### 5 Connect to Flow Source

- Connect an oxygen or blended oxygen/air supply to gas inlet port using gas supply line.
- ⚠ Consult local or international resuscitation guidelines (ILCOR) for recommended starting  $\text{FiO}_2$ .

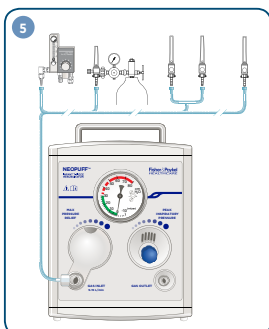

### 6 Set Flowrate

- Adjust the flow rate to the prescribed input flow rate between 8 and 15 L/min.
- Recommended flow rate: 8 L/min.

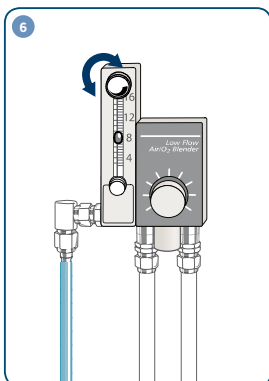

*This swingtag is only to be used as a guide to set-up. Always read and understand all user instructions for each component before use.*

### 7 Set Humidifier

- Turn on the humidifier base.
- MR850 – Check the humidifier is set to invasive mode. If not hold the mode button until the invasive mode light is lit.
- MR810 – Set the humidifier to high mode. Ensure the green heater wire light is lit.

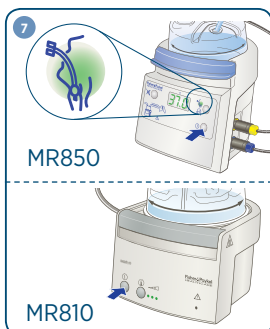

### 8a To Check Max Pressure

- Insert test lung or occlude patient T-Piece.
- Occlude PEEP (Positive End Expiratory Pressure) cap (white) with thumb or finger. Turn PIP (Peak Inspiratory Pressure) control fully clockwise, until the knob doesn't turn anymore.

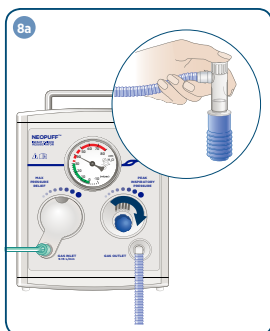

### 8b To Check Max Pressure

Adjust max pressure control knob clockwise or counterclockwise to set desired max pressure.

#### Note:

- The factory setting of the Max Pressure Relief is 40 cmH<sub>2</sub>O [mbar].
- The Max Pressure Relief valve acts as an overall limit on the achievable circuit pressure. Resuscitation above 40 cmH<sub>2</sub>O [mbar] cannot be achieved unless the Max Pressure Relief valve is adjusted.

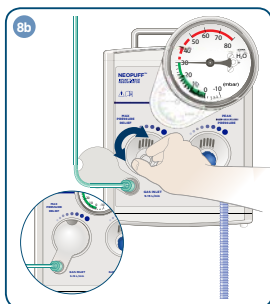

*This swingtag is only to be used as a guide to set-up. Always read and understand all user instructions for each component before use.*

### 9 Set PIP

- Ensure the test lung is inserted into the patient T-Piece. Occlude PEEP cap for adjustment and setting of PIP.

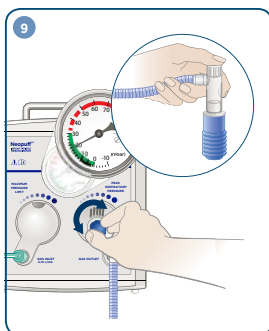

### 10 Set PEEP

- Adjust PEEP cap to the desired PEEP level.

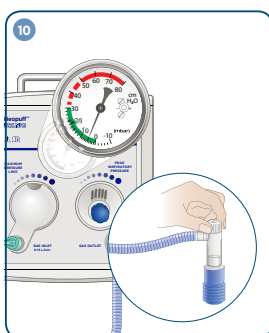

### To Resuscitate

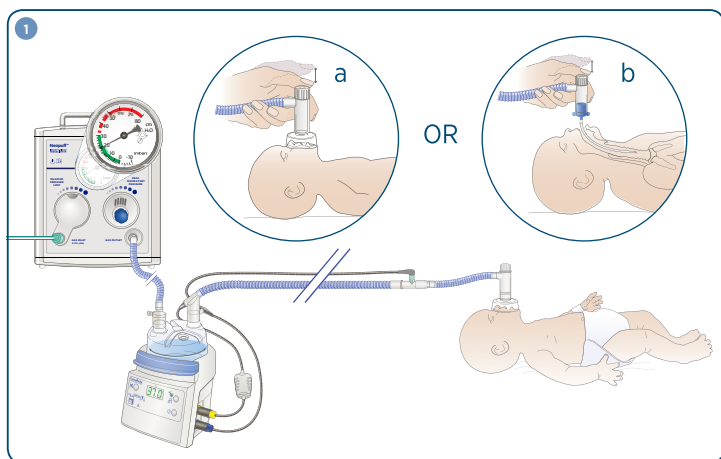

#### 1 Check Set-up

- Ensure flowrate is set to appropriate setting.
  - Check pressures - connect test lung to the T-Piece circuit and check PEEP and PIP settings are displayed on the manometer
  - a. Fit T-Piece to neonatal resuscitation mask and place over the baby's mouth and nose.
- OR
- b. Fit T-Piece to the endotracheal tube.

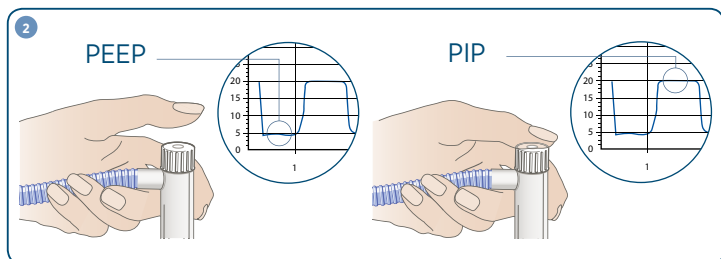

#### 2 Resuscitate

- Resuscitate by placing and removing thumb over the PEEP cap to allow inspiration and expiration.
- ⚠ Consult local or international resuscitation guidelines for full guidance on neonatal resuscitation.



*This swingtag is only to be used as a guide to set-up. Always read and understand all user instructions for each component before use.*