

1 Set-up

The following procedure should be carried out prior to every use of the F&P Neopuff™ to ensure that the device is functioning correctly.

- 1 Check the manometer reads zero with no gas flow. If not, the manometer requires calibration (refer to section 3.7.1 of the Technical Manual).

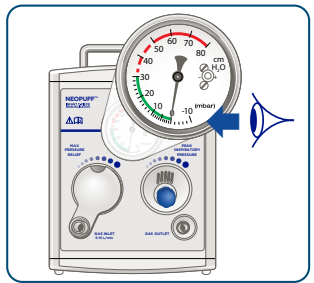

2 Connect Gas Supply

Connect an oxygen or blended oxygen/air supply to the gas inlet port using the gas supply line.

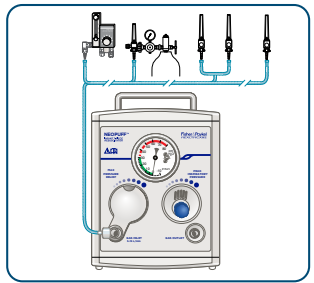

3 Connect T-piece Circuit

- Connect the T-piece circuit to the gas outlet port.
- If using the Ergonomic T-piece **i** leave the blue cap in place on the T-piece circuit or connect Test Lung to the T-piece circuit. If using the Classic T-piece **ii** connect a test lung to the T-piece circuit. Before use, inspect the test lung for signs of damage such as discoloration.

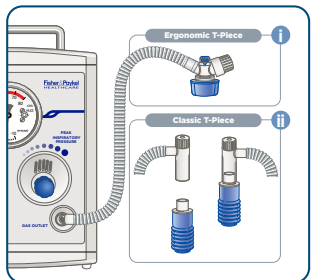

4 Check Settings

Adjust the gas supply to the desired flow rate between 5 and 15 L/min.

Note: Ensure the oxygen concentration of an oxygen/air supply is either monitored using an oxygen analyzer or preset using oxygen/air flow-rate graphs. The recommendation is 10 L/min for neonates > 8 kg in weight.

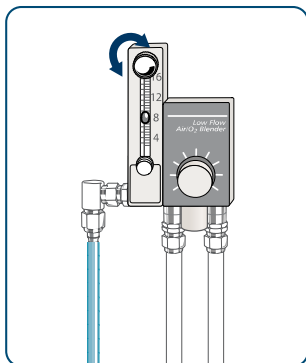

5a To Check Max Pressure

Occlude the PEEP¹ cap and turn the PIP² control fully clockwise, until the knob doesn't turn anymore (i or ii).

1. Positive end-expiratory pressure
2. Peak inspiratory pressure

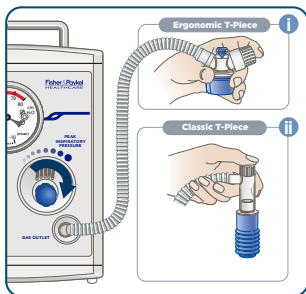

5b Adjust the max pressure control knob clockwise or counterclockwise to set the desired max pressure.

Notes:

- The factory setting of the Max Pressure Relief is 40 cmH₂O [mbar].
- The Max Pressure Relief valve acts as an overall limit on the achievable circuit pressure. Resuscitation above 40 cmH₂O [mbar] cannot be achieved unless the Max Pressure Relief valve is adjusted.

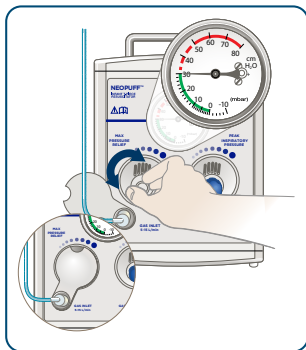

This swingtag is only to be used as a guide to setup. Always read and understand all user instructions for each component before use.

6 To Set PIP

While still occluding the PEEP cap, turn the PIP control knob counterclockwise until the desired PIP has been set (i or ii).

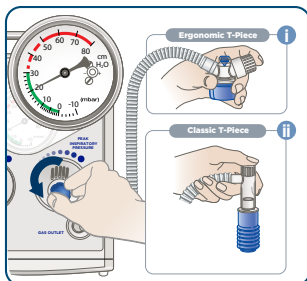

7 To Set PEEP

Adjust the PEEP cap to the desired PEEP level.

Turn off the gas supply and remove the test lung from the T-piece circuit. Ensure that the rigid plastic connector of the test lung is also removed from the T-piece circuit before attempting to connect a mask or endotracheal tube. Failing to do so may cause unacceptable delays during patient resuscitation (i or ii).

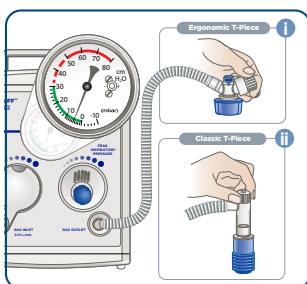

This swingtag is only to be used as a guide to setup. Always read and understand all user instructions for each component before use.

II To Resuscitate

- 8** Adjust the gas supply to the desired flow rate. This should be the same flow that was set during setup.

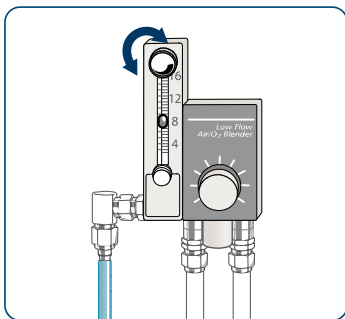

- 9** Fit the T-piece circuit to the neonatal resuscitation mask and place over the baby's mouth and nose.

Resuscitate by placing and removing a finger or thumb over the PEEP¹ cap to allow inspiration and expiration (i or ii).

1. Positive end-expiratory pressure

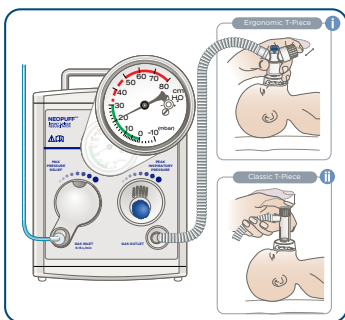

- 10** OR
Fit the T-piece circuit to the endotracheal tube.

Resuscitate by placing and removing a finger or thumb over the PEEP¹ cap to allow inspiration and expiration (i or ii).

1. Positive end-expiratory pressure

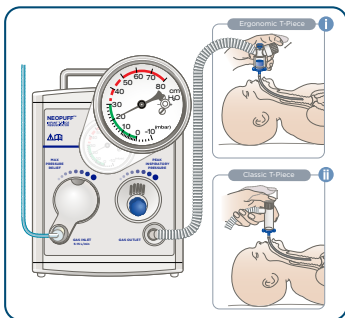

This swingtag is only to be used as a guide to setup. Always read and understand all user instructions for each component before use.