

### Warnings:

- Please read and understand the instructions fully before using the Neopuff Infant Resuscitator and related accessories. The Neopuff Infant Resuscitator is to be used only by persons trained in infant resuscitation.
- It is the responsibility of the purchaser to ensure that all users of this device have been adequately trained in resuscitation techniques.

### Set-up

**⚠** Consult the user instructions for the F&P Neopuff™ Infant T-piece Resuscitation Device, MR850/MR810 Humidifier and MR225/MR290 Humidification Chambers for additional user information and warnings.

#### 1 Insert Humidification Chamber

**⚠** Discard the chamber if the seals are not intact when received.

- Slide a MR225 or MR290 chamber onto the humidifier base.
- Remove the blue caps.
- If using a manual-fill chamber (MR225), fill with 30 mL of sterile water or equivalent. This will allow for 60 minutes of running time (at 8 L/min flow-rate) and then refill as necessary during resuscitation.

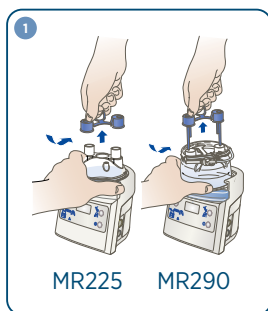

#### 2 MR290 - Connect Water Bag

- Hang the water bag, unwind the waterfeed set and spike the water bag.
- Open the vent on the vented spike.
- Check the humidification chamber for water flow from the bag.
- If no water is visible in the chamber or the water consumption is low, check that the bag is spiked properly and that the feed tube is not kinked or blocked. Try gently squeezing the bag to promote water flow. Ensure that the height of the water bag is at least 50 cm higher than the humidification chamber.
- Discard the chamber if the water level exceeds the maximum water level line.

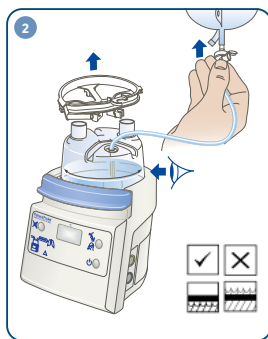

#### 3 Connect Circuit between the Neopuff and Chamber

- Connect the blue dryline circuit (without heater wire) between the Neopuff gas outlet port and one of the chamber inlet ports.

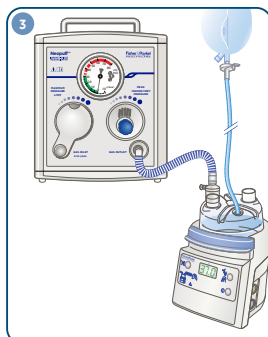

### 4 Connect T-piece Circuit

- Connect the blue inspiratory tube (with T-piece) to the remaining chamber port.
- Open the two blue caps on the inspiratory tube and insert the temperature probes.
- Plug the temperature probe into the humidifier (blue plug).
- Insert the heater-wire adapter into the humidifier (yellow plug) and then insert the probe into the end of the blue inspiratory tube (close to chamber).
- Ensure that the temperature probes and the heater wire adapter are fully inserted. If temperature probes are not used (i.e. using MR810), ensure the two blue caps are placed over the ports.

⚠ Discard the blue inspiratory tube if the heater wire (within tube) is not evenly distributed along the circuit length and is bunched or kinked.

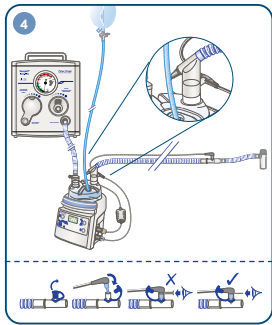

### 5 Connect to Flow Source

- Connect an oxygen or blended oxygen/air supply to the gas inlet port using the gas supply line.

⚠ Consult local or international resuscitation guidelines (ILCOR) for the recommended starting  $FiO_2$ .

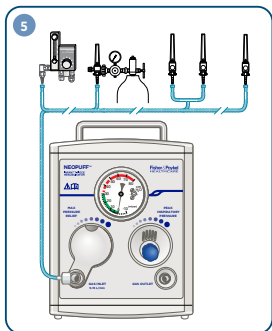

### 6 Set Flow rate

- Adjust the flow rate to the prescribed input flow rate between 8 and 10 L/min.
- Recommended flow rate: 8 L/min.

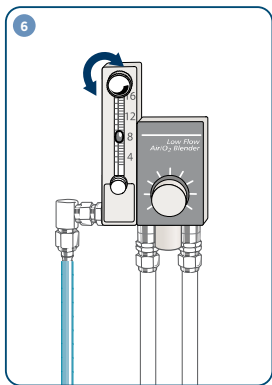

*This swingtag is only to be used as a guide to setup. Always read and understand all user instructions for each component before use.*

### 7 Set Humidifier

- Turn on the humidifier base.
- MR850 – Check the humidifier is set to invasive mode. If not, hold the mode button until the invasive mode light is lit.
- MR810 – Set the humidifier to high mode. Ensure the green heater-wire light is lit.

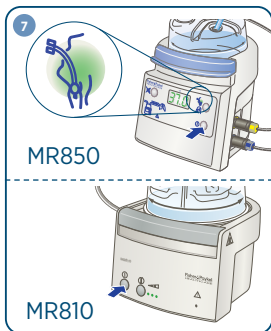

### 8a To Check Max Pressure

- Insert the test lung or occlude the patient's T-piece circuit.
- Occlude the PEEP (positive end-expiratory pressure) cap (white) with a thumb or finger. Turn the PIP (peak inspiratory pressure) control fully clockwise, until the knob doesn't turn anymore.

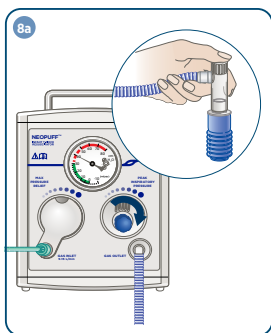

### 8b To Check Max Pressure

- Adjust the max pressure control knob clockwise or counterclockwise to set the desired max pressure.

#### Notes:

- The factory setting of the Max Pressure Relief is 40 cmH<sub>2</sub>O [mbar].
- The Max Pressure Relief valve acts as an overall limit on the achievable circuit pressure. Resuscitation above 40 cmH<sub>2</sub>O [mbar] cannot be achieved unless the Max Pressure Relief valve is adjusted.

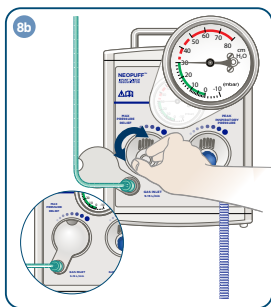

### 9 Set PIP

- Ensure the test lung is inserted into the patient's T-piece circuit. Occlude the PEEP cap for adjustment and setting of the PIP.

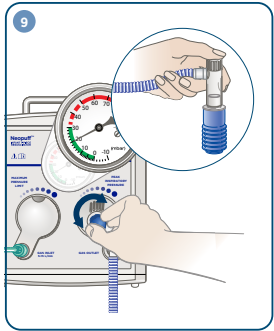

### 10 Set PEEP

- Adjust the PEEP cap to the desired PEEP level.

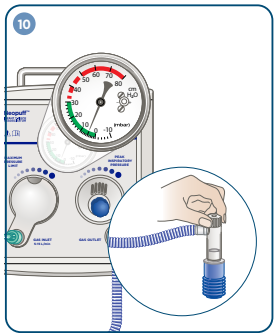

*This swingtag is only to be used as a guide to setup. Always read and understand all user instructions for each component before use.*

### To Resuscitate

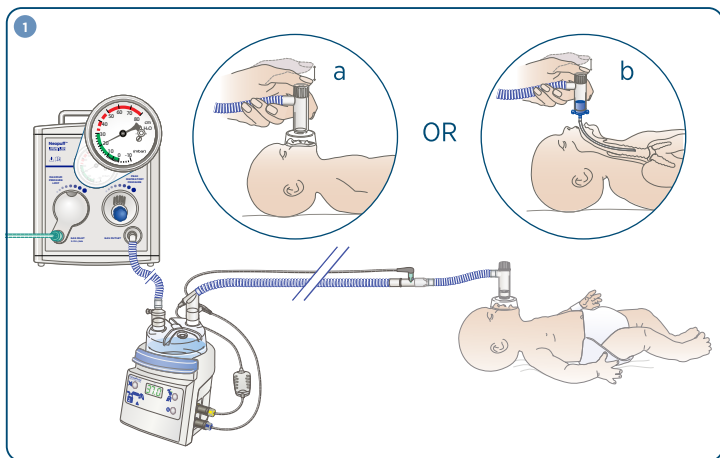

#### 1 Check Set-up

- Ensure the flow rate is set to the appropriate setting.
  - Check pressures – connect the test lung to the T-piece circuit and check that the PEEP and PIP settings are displayed on the manometer.
- a. Fit T-piece circuit to the neonatal resuscitation mask and place over the baby's mouth and nose.
- OR
- b. Fit the T-piece circuit to the endotracheal tube.

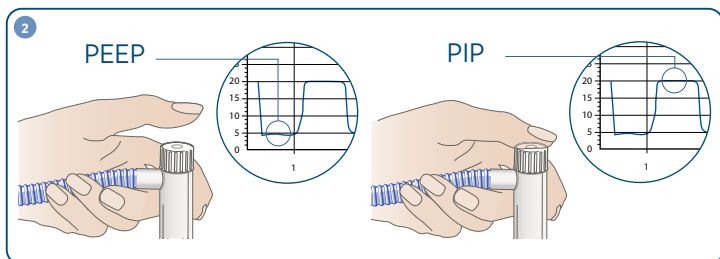

#### 2 Resuscitate

- Resuscitate by placing and removing a thumb over the PEEP cap to allow inspiration and expiration.
- ⚠ Consult local or international resuscitation guidelines for full guidance on neonatal resuscitation.